



**Model: PS-1000-6B**

Description:..... 6-Way Power Divider  
 Operating Frequency:..... 30–800 MHz  
 Insertion Loss / Amplitude Balance / Phase Balance:

| Frequency     | Insertion Loss | Ampl. Bal   | Phase Bal. |
|---------------|----------------|-------------|------------|
| 30 - 500 MHz  | 1.3dB Max      | ±0.2dB Max  | ±3°Max     |
| 500 - 800 MHz | 1.5dB Max      | ±0.5 dB Max | ±4°Max     |

Isolation: ..... 25 dB Min  
 VSWR: ..... Σ Port ..... 1.6:1 Max  
 ..... Output Ports ..... 1.5:1 Max  
 Power Handling (@ SUM-Port): ..... Load VSWR=∞ ..... 2W AVG/CW Max  
 ..... Load VSWR <2:1 ..... 8W AVG/CW Max  
 Connectors: ..... BNC (f)  
 Impedance: ..... 50 Ohms Nominal  
 Quality: ..... Best-Commercial-Grade

**Environmental Ratings:**

Temperature:..... {Operating: -55°C to +95°C} & {Storage: -60°C to +110°C}  
 Humidity: ..... MIL-STD-202F, Method 103B, Cond. B (96 hours at 95% R.H.)  
 Shock: ..... MIL-STD-202F, Method 213B, Cond. B (75G, 6mSec)  
 Vibration: ..... MIL-STD-202F, Method 204D, Cond. B (.06" double amplitude, or 15G)  
 Altitude: ..... MIL-STD-202F, Method 105C, Cond. B (50,000 Feet)  
 Temp. Shock: ..... MIL-STD-202F, Method 107D, Cond. A (5 cycles)

**Outline**

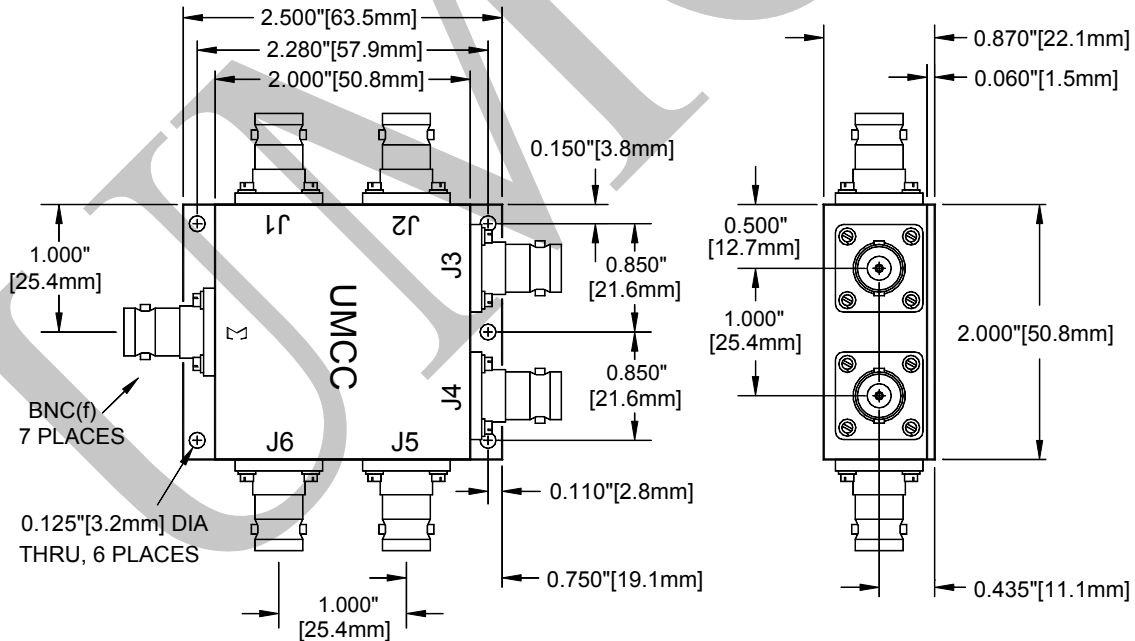

| Weight | Tolerances             |
|--------|------------------------|
|        | ± 0.015" [ ± 0.38 mm ] |